

2006 IBC CODE INFORMATION		
CODE ITEM REFERENCE	CODE REQUIREMENT	ACTUAL BUILDING DESIGN
OCCUPANCY SECTION 503.1	A-3 ASSEMBLY	A-3 ASSEMBLY
CONSTRUCTION TYPE TABLE 502	TYPE 3-B FIRE SPRINKLED	TYPE 3-B FIRE SPRINKLED
ALLOWABLE BUILDING AREA / ALLOWABLE AREA INCREASE SECTION 506	<p>BUILDING AREA ASSUMPTION: 1. SITE ALLOWS CLEAR SIDE YARDS OF 50 FEET OR MORE ON ALL SIDES OF BUILDING</p> <p>STANDARD AREA FORMULA: $A = A_1 \cdot \left(\frac{A_2}{A_1} \right)^{0.5}$ (IBC SECTION 506.1)</p> <p>STANDARD FRONTAGE INCREASE FORMULA: $1 + 100E \cdot (0.25)^{1/2}$ (IBC SECTION 506.2)</p> <p>TYPE V-B HEIGHT: $+40FT./STORIES$ (TABLE 503)</p> <p>BASIC AREA: $A = 6,000S.F.$ (TABLE 503)</p> <p>L: $1000 \cdot \frac{540 - 0.25 \cdot 130}{1540 - 130}$</p> <p>1: $1000 \cdot 1 - 0.25 \cdot 1$</p> <p>1: $1000 \cdot 75 \cdot 1$</p> <p>1: 75</p> <p>A: $6,000S.F. \cdot (6,000 \times 0.75) - (6,000 \times 3)$</p> <p>A: $6,000S.F. \cdot (4,500) \cdot (18,000)$</p> <p>A: $28,500S.F.$, EACH FLOOR (IBC SECTION 506.4)</p> <p>NOTE: THE FLOOR ABOVE VARIES DEPENDING ON ALLOWABLE SIDE YARD CLEARANCE AND SIZE. THE FIGURE ABOVE IS A MAXIMUM TOTAL FIGURE.</p>	ACTUAL AREA: 10,909 S.F.
MAXIMUM HEIGHT TABLE 503	40 FEET/1 STORES	1 STORY 28'-9" SPIRE 37'-5" + 66'-2"
ROOF COVERING TABLE 1505.1	CLASS C FIRE-RESISTANCE	CLASS A FIRE-RESISTANCE
DRAFT STOPS	717.3.3 & 717.4.3 EXCEPTIONS NOT REQUIRED IN BUILDING WITH SPRINKLERS WITH SPRINKLERS SYSTEM: STAIRS 0.2/OCCUPANT OTHERS 0.15/OCCUPANT	SEE ADJACENT EXIT PLAN
EGRESS WIDTH TABLE 1005.1		
RESTROOM ACCESSIBILITY SECTION 109.2.1	ANSI A117.1 GROUP A OCCUPANT - 1 UNISEX TOILET	1 ACCESSIBLE FIXTURE TYPE FOR EACH RESTROOM, 1 UNISEX TOILET
ACCESSIBLE ENTRANCE SECTION 105.1	AT LEAST 60% OF ALL PUBLIC ENTRANCES SHALL BE ACCESSIBLE	PROVIDED

PLUMBING FIXTURE COUNT TABLE 2902.1			
582 OCCUPANTS			
WATER CLOSETS	LAVS	DRINKING FOUNTAINS	SERVICE SINKS
MEN 291/150-2	1:200 = 2	1 PER 1,000	1 REQUIRED
WOMEN 291/75-4	1:200 = 2		
PROVIDED			
MEN URINALS - 2	MEN - 2	MAIN FLOOR 4	MAIN FLOOR 1
WOMEN - 4	WOMEN - 3		

OCCUPANCY CRITERIA

TOTAL OCCUPANT LOAD FOR ALL OCCUPANCIES- 582
EXITING PLAN COMPLIES WITH IBC

LEGEND

SYMBOL	DESCRIPTION
152 SF	ROOM SQUARE FOOTAGES
208 54	OCCUPANT LOAD SERVED BY EXIT
U	NOT COUNTED IN TOTAL OCCUPANT LOAD
72	ROOM OCCUPANT LOAD AT 7 SQ. FT. PER PERSON
20	ROOM OCCUPANT LOAD AT 20 SQ. FT. PER PERSON
2	ROOM OCCUPANT LOAD AT 100 SQ. FT. PER PERSON

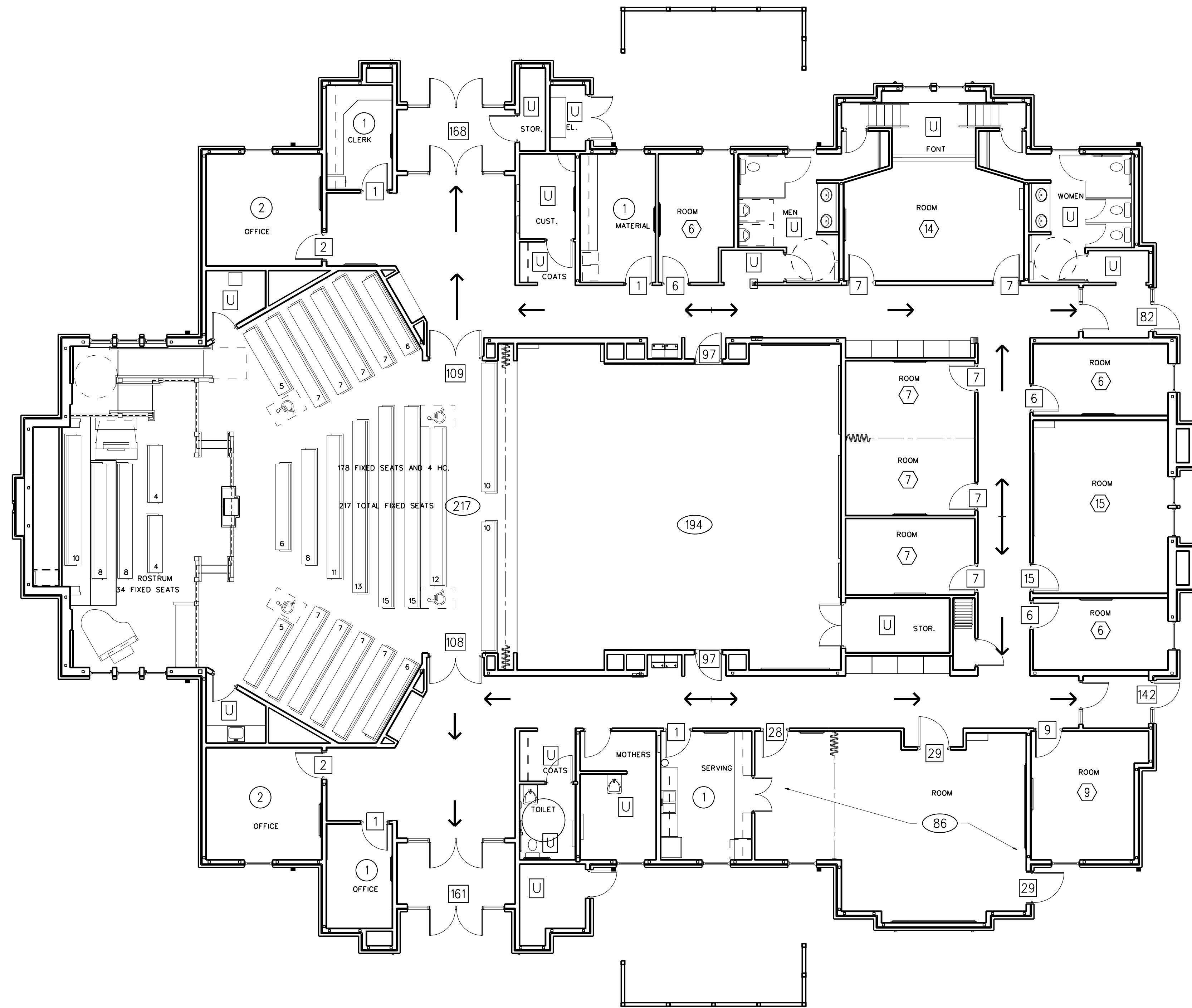

1 EXITING FLOOR PLAN
1/16" = 1'-0"

Architect/Engineer:

AZAR WALS
ARCHITECTS
American Institute of Architects AIA

* 401 CHERRY STREET SUITE 700
MACON, GEORGIA 31201 -USA
TEL: 478 282 7117
FAX: 478 750 9192
E-MAIL: info@azarwalsh.com

Stamp:



THOMASTON, GA BRANCH
JONESBORO, GA STAKE
HWY. 36 nr ROCK HILL SCHOOL ROAD
THOMASTON, GA. 30286

Project for:
THE CHURCH OF
JESUS CHRIST
OF LATTER-DAY SAINTS

Mark	Date (m-y)	Description

Architect Project Number:
0805
Plan Series:
FAY-170-02-[07]-02
Project Number:
500-0881-08020101

Sheet Title:
CODE
INFORMATION
IBC

Sheet:
G002
Of 02

Date: MAR. 16, 2009